



www.LostParadiseCharters.com



Your Adventure

Mikumba II is a beautiful, fully equipped traditional wooden boat that searches for adventure and gets away from the crowd.

We will take you to the most stunning locations, where our onboard guides will help you explore perfect empty beaches, uninhabited islands and pristine reefs rich in marine life.

Whilst at these idyllic locations the activities begin with a choice of diving, snorkelling, stand up paddle boarding, kayaking, subwing, surfing, fishing or simply relaxing on deck.



Komodo

March 2018 - June 2018

Komodo National Park is a UNESCO world Heritage site and has been selected as one of the new seven wonders of nature. Famous for its Komodo dragons, the largest lizards on earth, it is the only place in the world you can see them in the wild. But that's not all this central Indonesian Archipelago has to offer.

Home to over 250 species of Coral, manta rays, turtles, whales, dolphins, sharks and rich marine biodiversity have insured its place as a world-class destination for diving and snorkelling. As well as visiting the Komodo dragons there is much to see and do on land, short treks up the hills to unforgettable vistas for sunrise or sunset and breathtaking empty beaches, including one of a few pink beaches. The park is made up of three main islands - Komodo, Padar, Rinca and 26 smaller islands dotted throughout these stunning azure waters.



Komodo Sample Itinerary

Day 1

Board boat 10am at Labuan Bajo harbour. After safety briefing we will cruise to the North of the National Park and explore the pristine reefs, secluded bays and beaches surrounding the islands of Lawa Laut and Lawa Darat. Anchor overnight in a sheltered bay in the North of Komodo Island.

Day 2

The day begins with a short trek to watch the sunrise over the North Part of the park. We then head to Makassar reef to have a close encounter snorkelling with Manta Rays. After lunch we take a short cruise to visit the pink beach on Komodo Island. Then we head to Padar Island to our anchorage for the night.

This is a suggested itinerary and can be extended to cover more of the National Park and get further afield, and tailored to meet your specific requirements and desires.

Day 3

The day starts with a sunrise trek to see the stunning view from Padar Island. We then head to explore the reefs and small islands in the area North of Rinca, perfect for trying all our onboard water toys. Anchor overnight in a sheltered bay at Rinca Island.

Day 4

It's off to see the Komodo Dragons. The park rangers will take us on a guided trek to see the dragons and other wildlife unique to the national park. We'll then start making our way back to Labuan Bajo at a leisurely pace, stopping at some of the smaller islands for more snorkelling and exploring. Disembark Labuan Bajo harbour at approximately 3:30pm

South Gili's

June 2018 - October 2018

Located in the southwest corner of Lombok, the Southern Gili's or secret Gili's as they are known comprise of 13 stunning islands that form a mini archipelago within an hour and a half fast boat ride from Bali.

The area brings a wander to the senses with uninhabited islands, white beaches and sparkling turquoise water and an amazing underwater world with pristine coral reefs rich in marine life.

You will visit the most beautiful islands, barbecue on deserted beaches and enjoy all the activities provided on-board. Protected by the southern Indian ocean swell, it makes for a perfect cruising conditions on the flat waters with breathtaking scenery.



South Gili's Sample Itinerary

Day 1

Pick up from hotel and transfer to Serangan Harbour where you will board Gili Getaway boat service at 9:30am to Kokomo Resort, Gili Gede, arriving at 11:30am. From here you board Mikumba II and cruise to Gili Nanggu, Gili Jangkong and Gili Sudak to explore these beautiful islands and their surrounding waters. Anchor overnight at Gili Sudak.

Day 2

After breakfast we head off to Gili Ringgit, Gili Layar and Gili Gede for a packed day of water activities or Island hopping visiting the local village of Gili Gede - the biggest island in this group. We end the day with a short trek on Gili Gede to watch the sunset from a stunning viewpoint. Anchor overnight at Gili Gede.

This is a suggested itinerary and can be extended to incorporate the Northern Gili's (Gili Trawangan, Gili Memo and Gili Air) and altered to enable you to embark / disembark at these popular tourist hotspots.

Day 3

We set off to Bangko Bangko for breakfast in this beautiful bay with traditional fishing village and great snorkelling. Then head to Gili Asahan and Gili Goleng for more water activities and exploring these picturesque islands. For sunset you can take a short trek on Gili Asahan for more stunning views whilst we prepare a BBQ on the beach on the deserted island of Gili Goleng. Anchor overnight at Gili Goleng

Day 4

We'll spend the morning doing your favourite activities at your favourite spots in the area or take time to simply relax and enjoy the scenery. At midday we'll cruise back to Kokomo resort on Gili Gede for lunch at their beachside restaurant. From here you will board the Gili Getaway fast boat back to Bali at 2:45pm and arrive back at Serangan harbour at 4:15pm and transfer to your end destination.

Mikumba II

Mikumba II was built in 2006 at the famous boat building village of Bulukumba, South Sulawesi, where a tradition of wooden boat construction spans half a millennium. In 2016 she was acquired by Lost Paradise Charters and underwent an extensive refit and overhaul to bring her up to the exacting standards of today's lifestyle Charter requirements.

Whilst the boat has been fitted with all modern amenities for maximum comfort, the interior designers have kept a traditional feel throughout. The creative use of teak, bamboo, rattan and local fabrics really gives a sense of the exotic and adds to the unique experience aboard Mikumba II.

The boat itself is unique in the fact she has the largest deck area (diving deck, lounge deck, dining deck) of any phinisi in her class. She is the only one with a swim/dive platform at the rear transom making easy access in and out of the water whilst enjoying paddle boarding, kayaking, swimming or simply jumping off the boat.

Vessel Dimensions & Cruising

Length: 28m

Gross Tonnage: 136

Beam: 7m

Draft: 3m

Engine: Mitsubishi 8dc 350hp

Genset 1: Mitsubishi 30KVA

Genset 2: Perkins 16KVA

Cruising speed: 8 knts

Cruising Range: 1600 NM

Areas: Indonesian Archipelago

The Boat

Accommodation

1 x Master Cabin with ensuite & private balcony

1 x Master Cabin with ensuite

3 x Double / Twin Cabins sharing 2 bathrooms

* All rooms with Air Conditioning

Facilities

Tender 1 - 5m RIB 50hp 4 Stroke outboard with fish finder & GPS

Tender 2 - 3m RIB 20hp 4 Stroke outboard

* Dive Equipment

* 2 x Kayak (Double and Single)

* 4 x Stand up paddle board

* Full Snorkelling equipment

* Surf & Boogie boards

* Fishing tackle

* 2 x Subwing



The Boat Layout

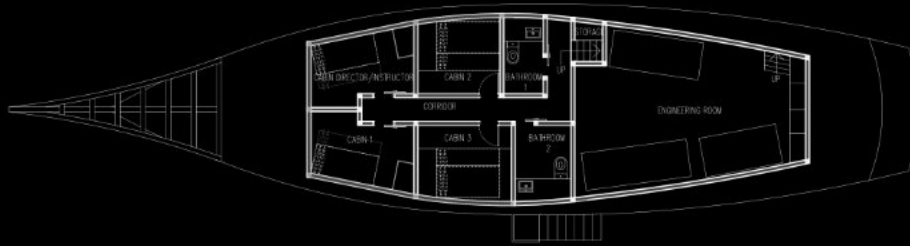

Lower Deck



Mid Deck

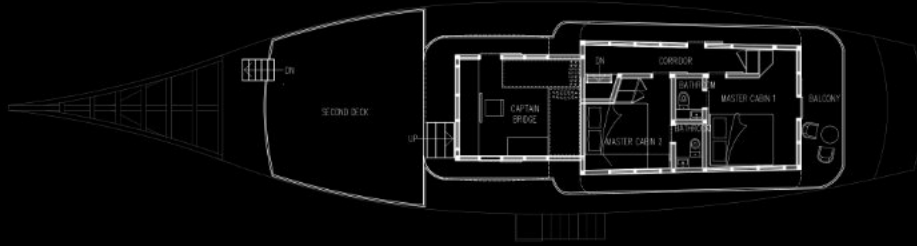

Upper Deck

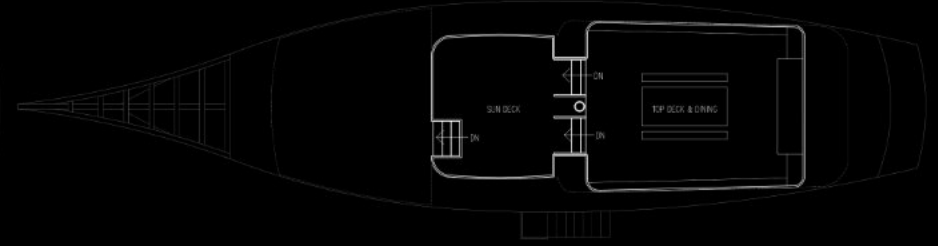

Top Deck

Price per night from \$2300 (USD) per night
(dependant on number of passengers and criteria)

Inclusions:

All meals and snacks

Soft drinks

Cruise director/instructor/guide

Full use of all onboard equipment / toys

Harbour and park fees

Local transfers

Diving upon request

Exclusions

Alcoholic beverages.

International or domestic flights

*** Sample package is charged for the 3 nights and NOT 4 days.

www.LostParadiseCharters.com

A two-deck motorboat is shown on the water at dusk. The boat has a canopy and is illuminated from within. The background features a range of mountains under a dark, cloudy sky. The water is dark with some reflections.